



I Application

The Prolac S pump is a sanitary centrifugal pump that meets the highest sanitary requirements for use in the food-processing and pharmaceutical industries. Some of its uses include processes in the brewing, dairy and beverage industries in general, and with the appropriate options it can also be used in complex applications such as evaporators, concentrators, distillation towers, decanting of syrups, and purified-water loops in the pharmaceutical industry.

I Operating principle

Housed inside the casing, the impeller rotates in conjunction with the pump shaft. With this arrangement, the impeller blades convey energy to the fluid in the form of kinetic energy and pressure energy.

This pump is not reversible by simple reversal of the direction of rotation. The direction of rotation is clockwise when the pump is viewed from the rear side of the motor.

I Design and features

Casing manufactured with cold-formed plate.

DIN connections.

Open impeller manufactured with stainless steel investment casting technology.

Sanitary mechanical seal.

Pump certified according to 3A sanitary standards.

Very robust stainless steel cast lantern.

IEC B5 motors (B14 for S-15, B35 motors T.200, 225, 250 and B3 for close-coupled models), IP55, F-class insulation.

Pump support from AISI 304.

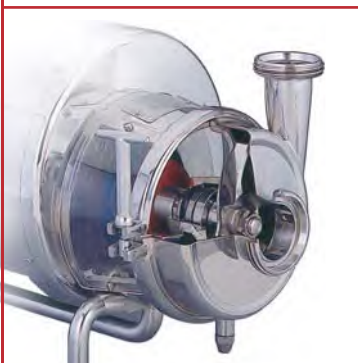

Shaft

I Materials

Parts in contact with pumped media:

AISI 316L

Other parts in stainless steel

AISI 304

Gaskets

EPDM

Mechanical seal

St.St/C/EPDM

Inside surface finishing

Ra < 0.8 µm.

Outside surface finishing

Mirror polished



I Options

- Bare-shaft construction for models S-35, S-38, S-70, and S-80.
- Mechanical seals in SiC/C, SiC/SiC or TgC/SiC.
- Cooled or double mechanical seal.
- Gaskets in FPM (Viton) and PTFE.
- Ra<0,4 surface finishing.
- Self-priming casing.
- Heating chamber.
- Drainage connection.
- Connections: Clamp, SMS, RJT, etc.
- Motors with additional protection.
- Trolley and/or switchboard.

I Technical specifications

Max.flow	425 m ³ /h	1880GPM
Max.head	200 mcl	290 ft
Max.suction pressure	4 bar	58 PSI
Max.working temperature	120°C	248°F
Max.speed	3500 min ⁻¹	

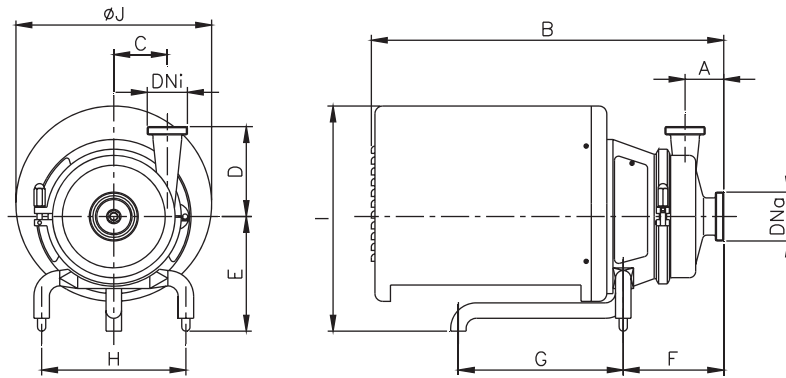

PUMP	Motor size	DNa	DNi	A	B	C	D	E	F	G	H	I	ØJ	
S-15	A	71	40 1½"	32 1½"	55	415	55	100	130	137	175	155	260	220
S-20	B	80	50	40	55	485	74	140	165	152	235	205	325	270
	C	90	2"	1½"										
S-26	B	80	65	50	55	495	72	150	165	162	235	205	325	270
	E	100/112	3"	2"		575			190	172	275	205	375	330
S-28	B	80	40	40	65	485	107	165	165	156	235	205	325	270
	C	90	1½"	1½"		570			190	166	275		375	330
	E	100/112							190	166	275		375	330
S-35	C	90	65	50	75	500	104	175	165	170	235	205	325	270
	F	132	3"	2"		685			230	193	320	280	445	380
S-38	C	90	100	65	75	500	98	180	165	170	235	205	325	270
	E	100/112	4"	3"		585			190	180	275		375	330
	G	160				870			280	237	355	320	555	465
	H	180									425			
S-70	F	132	100	65	92	735	148	212	280	243	355	320	555	465
	G	160	4"	3"		880			280	243	355		555	465
	H	180									425			
S-80	G	160	125	100	115	903	195	230	280	270	355	320	555	465
	H	180	5"	4"							425			

Dimensions with DIN 11851 connections



The information contained in this brochure is for guidance only. We reserve the right to modify any material or feature without notice in advance.



FL.Prolac.1.EN-0604